

- When sending reels for repair service to our authorized service center, please indicate the problems. (For example: anti-reverse malfunction) If there is no TICA authorized service center near you, please contact TICA USA, Inc., 1450-Q West Pointe Dr., West Pointe Business Park, Charlotte, NC 28214, Tel: (800) 390-5268 Fax: (800) 390-5298.
- If you are repairing your own reel and need to order parts from TICA USA, Inc., please indicate part numbers from the part list.

REPAIR SERVICES

We have assigned product code and part number to the reel and their parts. Product code showed in this operating instruction. Part number showed in the part list. When making inquiry, please specify the model number and product code.  
for example: Model Number - VENUS GD3059  
Product Code - TA213020  
**Attention:**  
We will be pleased to answer any questions of yours beside the information we inform with this sheet.

INFORMATION

INFORMATION & REPAIR SERVICES

VENUS GD

Operating Instructions

Thank you for choosing TICA'S VENUS spinning reel.

TICA'S VENUS spinning reels were designed by fishing pros..Please read these instructions before using this excellent, high quality reel. To obtain the most fishing enjoyment.



PICTOMARKS AT A GLANCE



7 ball bearings



INSTANT ANTI-REVERSE

Instant anti-reverse



COMPUTER BALANCED

Balance rotor



WORM SHAFT SYSTEM

Worm shaft system for even line winding



- Wash the dirt and sand off the reel with lukewarm water and wipe it dry with a soft cloth.
- The reel should not be immersed in water.
- Applied a light coat of grease or a few drops of oil to the moving parts on handle, ball spring, bail trip and anti-reverse switch.
- The gear, main shaft and ball bearings should be oil periodically to insure top performance.

MAINTENANCE



- Do not put reel in the dirt, sand or salt water, which are corrosive.
- When the fish line was tangled with underwater objects, do not jerk with the rod to free the line. Hold the line and cut it off.
- Handle your fishing equipment carefully, especially at the shore or beach rock.
- When stick the rod in the sand or rock, often the reel will be damaged by the sudden force.
- File the cutting edges off the reel seat on the fishing rod before you put on the reel.



OPERATION

Please follow these instructions to keep your reels in top-notch condition.

OPERATING INSTRUCTIONS

IMPORTANT SAFEGUARD

⚠ WARNING	
⚠	<ul style="list-style-type: none"><li>● Do not grab the fish line when the hooked fish is running with it.</li><li>● When anti-reverse switch is off, the handle could turn backward and hurt the hand.</li><li>● Do not reel in other-than fishing activities.</li><li>● The moving parts were applied with grease or lubricant which might soil your clothes.</li><li>● Do not put fingers against turning spool or rotor.</li></ul>
	<ul style="list-style-type: none"><li>● When retrieving, do not touch the turning parts.</li><li>● Do not put your fingers between spool and fish line.</li></ul>



BORN to PERFORM !

EVER WINNER INDUSTRIAL CO., LTD

<http://www.ticaglobal.com>  
E-mail: [service@ticaglobal.com](mailto:service@ticaglobal.com)

FEATURES

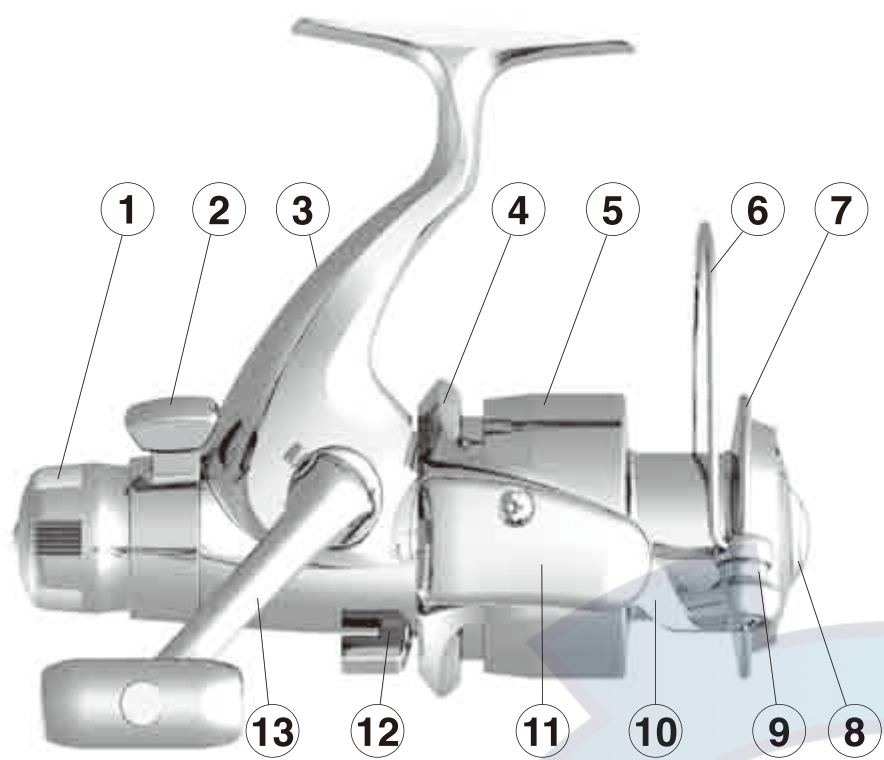

1. DRAG KNOB

2. FIGHTING LEVER

3. BODY

4. ROTOR

5. SPOOL

6. BAIL

7. SPOOL LIP

8. PUSH BUTTON
9. LINE ROLLER

10. BAIL ARM

11. STAINLESS STEEL BAIL SPRING COVER

12. ANTI-REVERSE LEVER

13. HANDLE

SPECIFICATIONS

Model No Product code	Gear Ratio	Line Retrieved Handle Turn (cm)	Weight (g)	Bearing		Line Capacity	
				B.B.	R.B.	lb-yds	NO.-m
GD3059 TA213020	5.2	74	360	7	1	8-222 10-200 12-180	3-200 4-150 5-110
GD3059H TA213050	6.3	89	360	7	1	8-222 10-200 12-180	3-200 4-150 5-110
GD3559 TA214020	5.2	80	370	7	1	10-270 12-250 14-220	4-200 5-150 6-130
GD3559H TA214070	6.3	97	370	7	1	10-270 12-250 14-220	4-200 5-150 6-130
GD4059 TA215020	5.2	85	505	7	1	12-300 14-270 17-220	4-230 5-190 6-150
GD4059H TA215070	6.3	103	505	7	1	12-300 14-270 17-220	4-230 5-190 6-150
GD4559 TA216020	5.2	91	515	7	1	14-330 17-270 20-180	5-240 6-200 8-150
GD4559H TA216070	6.3	111	515	7	1	14-330 17-270 20-180	5-240 6-200 8-150

★R.B. — Roller bearing

CHARACTERISTICS

- 7 precision ball bearings.

● A mini ball bearing in the line roller.

● Twist reduction designed line roller.

● Computer designed balanced rotor to reduce vibration.

● Coiled tension bail spring.

● Titanium plated stainless bail spring cover.

● High tensile strength plastic body.

● Instant anti-reverse device.

● Titanium plated stainless spool lip.
- A push button spool release.

● One-touch folding handle.

● Wooden handle knob.

● Worm shaft.

● Right/left interchangeable.

● Aluminum drag knob.

● Aluminum spool

● Fighting lever.

EXPLANATION ON THE MAIN FUNCTIONS AND USAGE

● SPOOLLING ON NEW LINE

1. Mount the reel on the rod.

2. String the line through the first guide and wind on the spool.

3. Tighten the drag.

4. Put a round rod through the fish line spool. Hold both end of the round rod and put on some pressure.

5. Retrieve the reel rotor to spool the line on the spool.

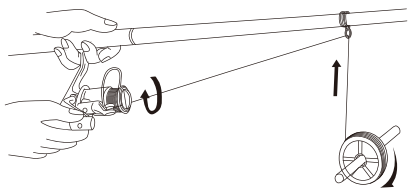

● PUT ON AND REMOVE THE SPOOL

Remove:

Place your forefinger and middle finger as shown. Then place your thumb on the button in the centre of the spool, press lightly and the spool will "pop" off.

Put on:

Set the brake lever on the maximum. Place the spool on the main shaft, and with little pressure and turning slightly to the right, the spool should return to its working position with a "click" sound.



● OPERATE THE FAST CAST LEVEL

1. Turn anti-reverse switch to ON position.

2. Hold the rod seat and put the reel foot between middle finger and the forefinger. Turn the handle backward until it stops.

3. Use index finger to pick up fish line and at the same time trig the fast cast level (Figure 1), cast the line to the target, the fast cast lever will return to the original position after cast.(Figure 2)

4. Turn the handle forward after line cast. The bail spring will be triggered back to retrieve the line.

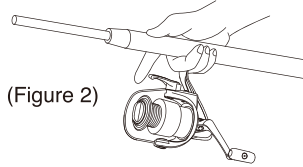
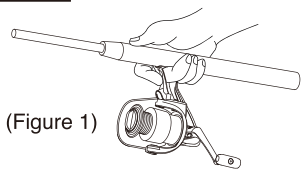

● DRAG ADJUSTMENT

Turn the drag knob clockwise to increase the dragtension, and counter-clockwise to loosen the drag tension.

You can find "fighting lever" is designed on each model of this series, so free and easy to pick up the right & best drag setting for yourself.

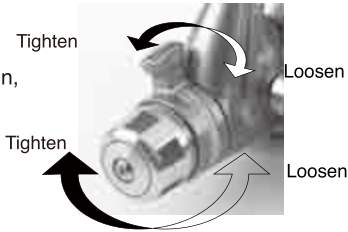

● YOUR "FIGHTING LEVER" IS YOUR BEST PARTNER WHEN FIGHTING FISH.TO USE TICA"FIGHTING LEVER"AND FIND THE BEST DRAG SETTING

1. First turn both the drag knob and "fighting lever" in the off position.Set the drag knob to the drag power required, and use the "fighting lever" to fine adjust your drag pressure while fighting fish, particularly when fishing lighter breaking strain lines. If more drag power is required simply adjust the drag knob to suit and continue using the "fighting lever" for fine adjustment.The TICA "fighting lever" system is designed to be effective even on line tension under 0~1kg.

2. Should you at any stage, find a slight loss of power in the "fighting lever" after long term usage, you can take the following steps to recover the power with these simple adjustments.

(1) Remove screw and drag knob . Pull out slightly retainer.

(2) Turn the "fighting lever" to the far left hand side and remove. Gently turn the lever brake to the right hand side.Never turn to the tightest condition.(Figure 1)

(3) Place the "fighting lever" back into its original position, taking care to seat the lever correctly. When tight and seated correctly, return the drag knob and screw back into position,and your TICA "fighting drag" is ready to give you many more hours of pleasurable fishing.(Figure 2)

LEVER BRAKE

(Figure 1)



FIGHTING LEVER

(Figure 2)

● SPOOL LINE CLIP

- 1.After the reel spool was winded up to the full capacity with fish line. Remove the spool from the rod. Hold the spool like the illustration at right.

2.Line your thumbnail with the line clip. Slide the fish line down along the thumbnail into the line clip.

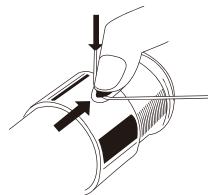

● RIGHT / LEFT HANDLE INTERCHANGE

1. Turn and remove handle screw cap.

2. Remove the handle and put in the slot from the other side.

3. Screw back the handle screw cap and be sure all the components were in the right places.

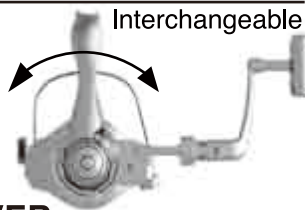

● ANTI-REVERSE LEVER

When anti-reverse switch is ON, the handle can be turn forward and retrieve the fish line only. When casting, the switch should be at OFF position.

